

WPWH-200

DOWNLOAD



Catalog



2D



3D

SAVE TO PDF / PRINT

PUBLICATION - 2017-11-07

TYPICAL APPLICATIONS

- pumping of pure or mechanically contaminated water with solids with the grain size of up to 2 mm,
 - pressure boosting,
 - technological processes,
 - industrial systems,
 - mining – main and auxiliary dewatering.
-

KEY ADVANTAGES

- long life ensured by the use of state-of-the-art corrosion- and erosion resistant materials,

- special material execution DUPLEX especially resistant to difficult conditions,
 - possibility to use an electronic system of the balance disk wear monitoring,
 - connection dimensions in compliance with multi-stage drainage pumps,
 - approved for operation in explosion-hazard zones - ATEX Ex I M2.
-

PUMP PERFORMANCE CURVE

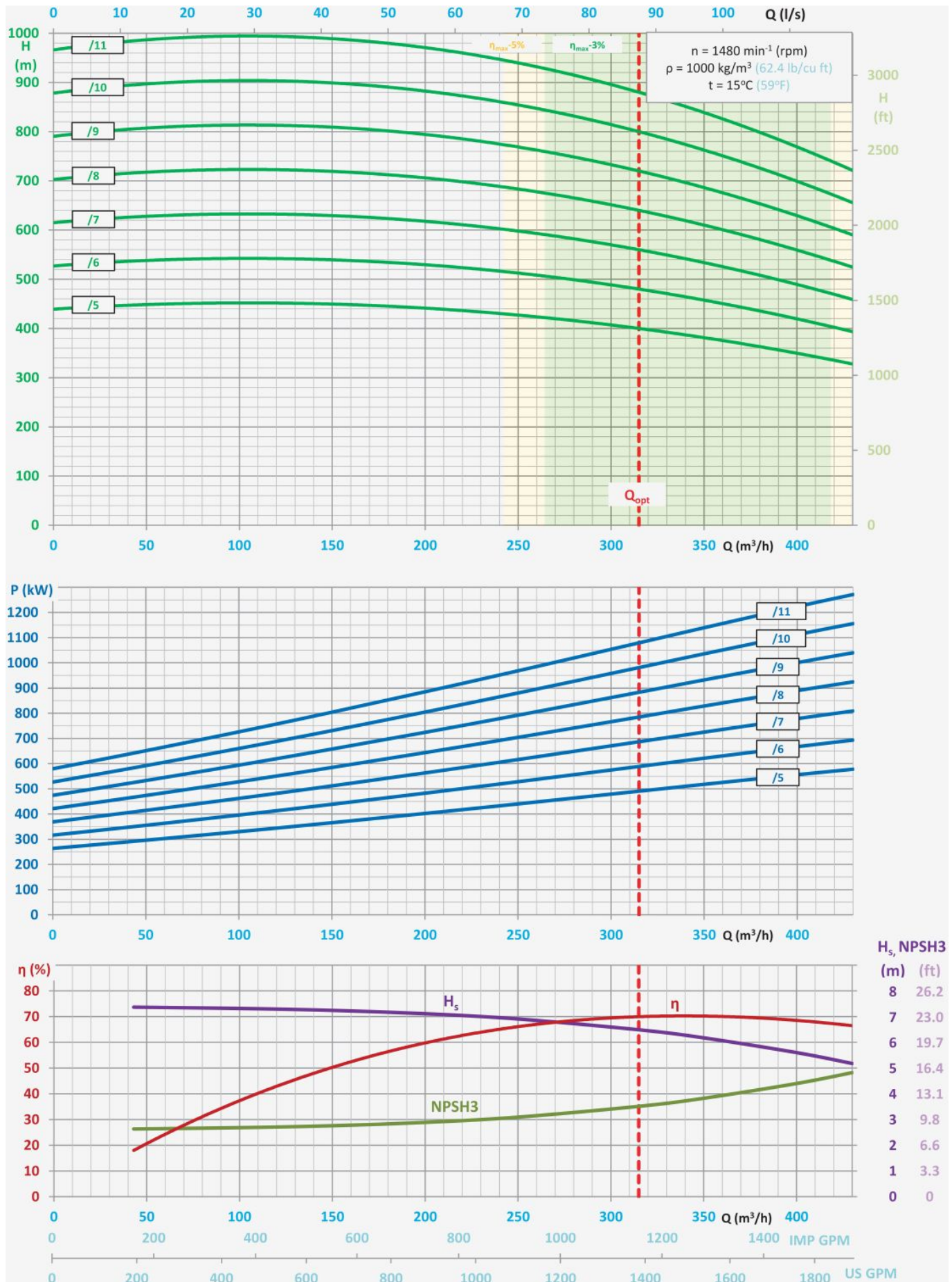

- $H = f(Q)$ - lift head acc. to rate flow,

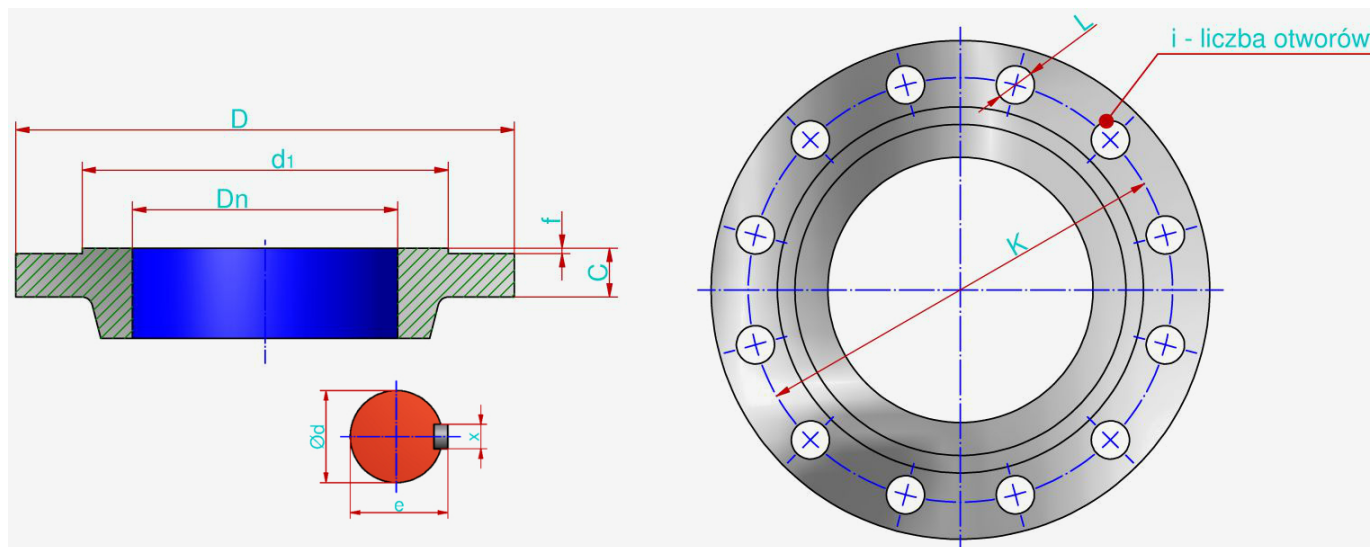

	P _n	D _n	D	K	L	i	C	f	d ₁	d	e	x
Suction connector	16	250	405	355	26	12	26	3	320	-	-	-
Discharge connector	63	200	415	345	36	12	42	2	285	-	-	-
	100	200	430	360	36	12	52	2	285	-	-	-
Shaft / coupling	-	-	-	-	-	-	-	-	-	100	106	28
	bar	mm	mm	mm	mm	-	mm	mm	mm	mm	mm	mm

The flanges are normally made in accordance with the standard PN-EN 1092-1 or PN-EN 1092-2.

It is possible to produce pumps with parameters different than those presented in the tables and on the graphs per agreement with the manufacturer.