

WPW-300

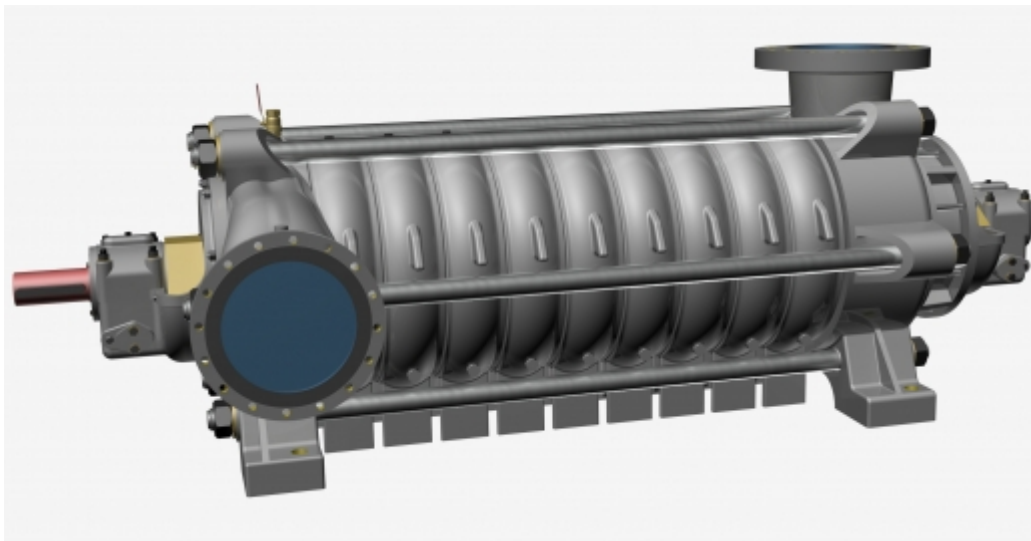

DOWNLOAD



Catalog



2D



3D

SAVE TO PDF / PRINT

PUBLICATION - 2017-11-07

TYPICAL APPLICATIONS

- pumping of pure or mechanically contaminated water with solids with the grain size of up to 2 mm,
- pressure boosting,

- technological processes,
 - industrial systems,
 - mining - main and auxiliary dewatering,
 - coal, copper, salt mines and others.
-

KEY ADVANTAGES

- long life ensured by the use of state-of-the-art corrosion- and erosion resistant materials,
 - special material execution DUPLEX especially resistant to difficult conditions,
 - possibility to use an electronic system of the balance disk wear monitoring,
 - connection dimensions in compliance with multi-stage drainage pumps,
 - approved for operation in explosion-hazard zones - ATEX Ex I M2.
-

PUMP PERFORMANCE CURVE

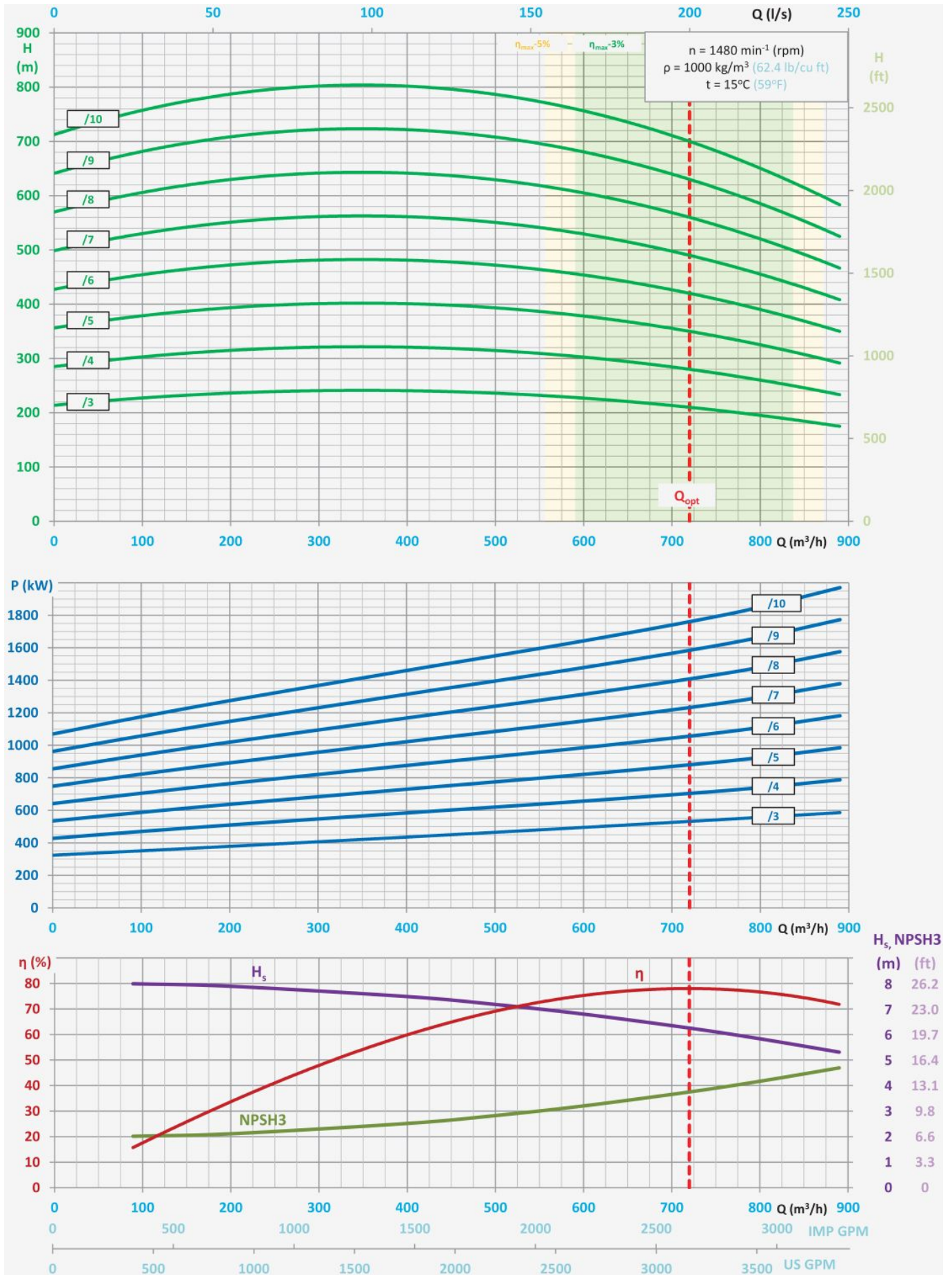

- $H = f(Q)$ - lift head acc. to rate flow,

- $P = f(Q)$ - power input acc. to rate flow,
- $\eta = f(Q)$ - efficiency acc. to rate of flow,
- $H_s = f(Q)$ - allowable suction head acc. to rate of flow,
- $NPSH3 = f(Q)$ - net positive suction head and rate of flow.

MAIN DIMENSIONS OF PUMP

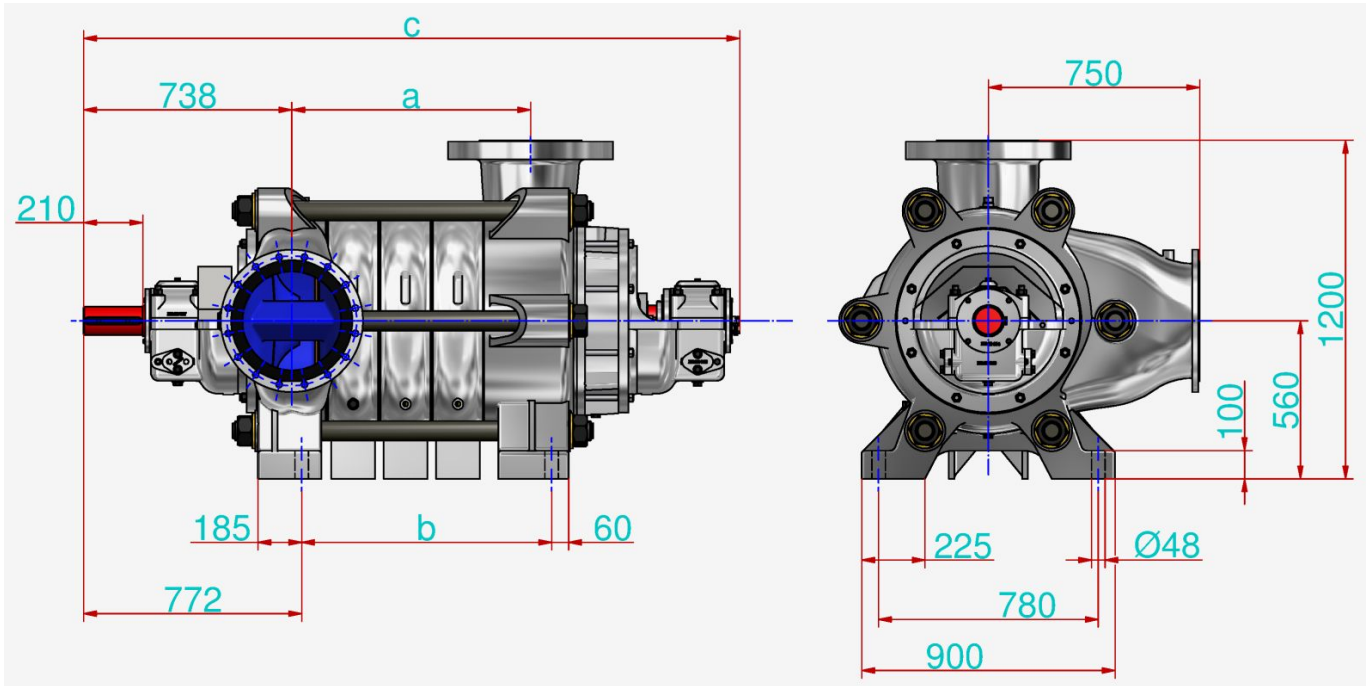

	Number of stages								
	single drive			dual drive					
	3	4	5	6	7	8	9	10	
a	2151	2337	2523	2709	3108	3294	3480	3666	mm
b	701	887	1073	1259	1445	1631	1817	2003	mm
c	659	845	1031	1217	1403	1589	1775	1961	mm

CONNECTION SIZES OF PUMP

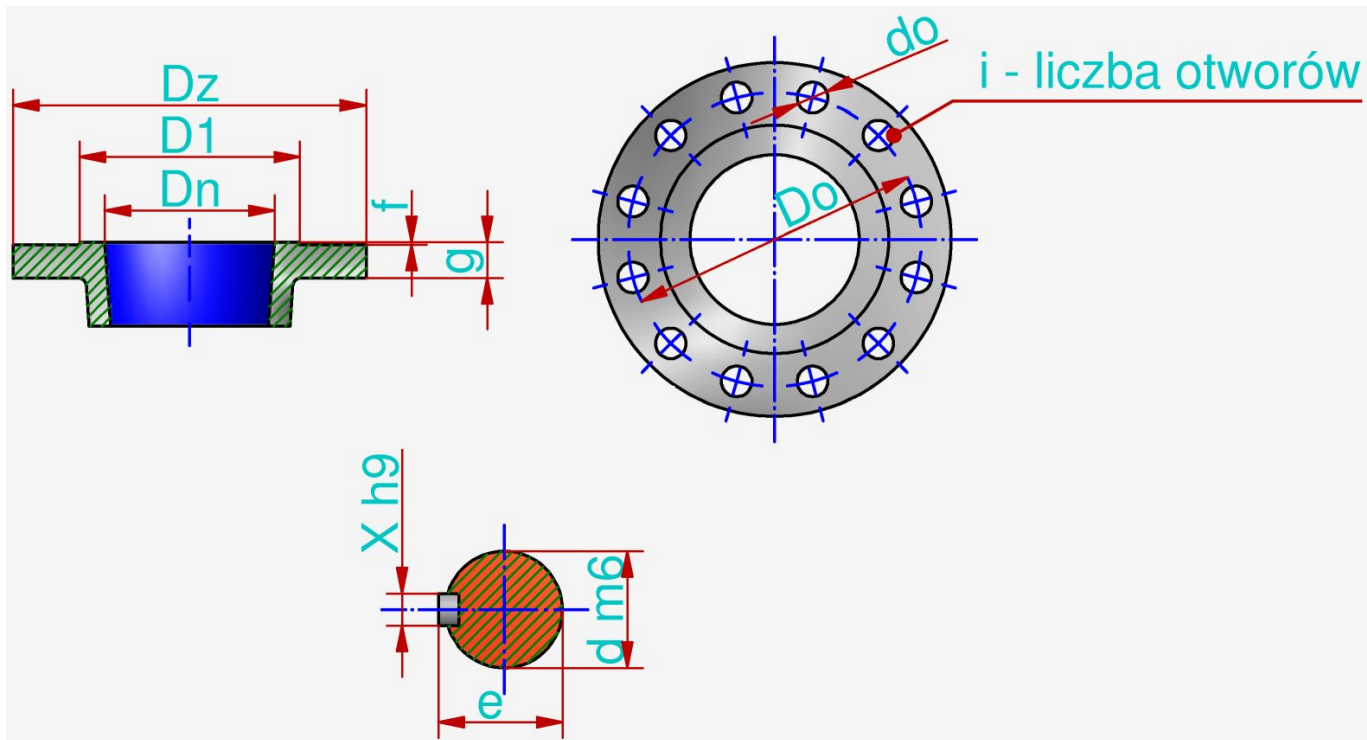

	D_n	Number of stages	P_n	D_z	d_o	g	F	D_o	D_1	i	d	e	x
Suction connector	350	-	10	505	22	26	4	460	460	16	-	-	-
		3÷5	40	515	33	42	4	450	410	-	-	-	-
Discharge connector	300	6÷8	63	530	36	52	5	460	363	16	-	-	-
		9÷10	100	585	42	68	5	500	363	-	-	-	-
Shaft / coupling	-	-	-	-	-	-	-	-	-	-	100	106	28
	mm	-	bar	mm	mm	mm	mm	mm	mm	-	mm	mm	mm

The flanges are normally made in accordance with the standard PN-EN 1092-1 or PN-EN 1092-2.

It is possible to produce pumps with parameters different than those presented in the tables and on the graphs per agreement with the manufacturer.