

WPW-250

DOWNLOAD



Catalog



2D



3D

SAVE TO PDF / PRINT

PUBLICATION - 2017-11-07

TYPICAL APPLICATIONS

- pumping of pure or mechanically contaminated water with solids with the grain size of up to 2 mm,
 - pressure boosting,
 - technological processes,
 - industrial systems,
 - mining – main and auxiliary dewatering,
 - coal, copper, salt mines and others.
-

TYPICAL APPLICATIONS

- pumping of pure or mechanically contaminated water with solids with the grain size of up to 2 mm,
 - pressure boosting,
 - technological processes,
 - industrial systems,
 - mining – main and auxiliary dewatering,
 - coal, copper, salt mines and others.
-

PUMP PERFORMANCE CURVE

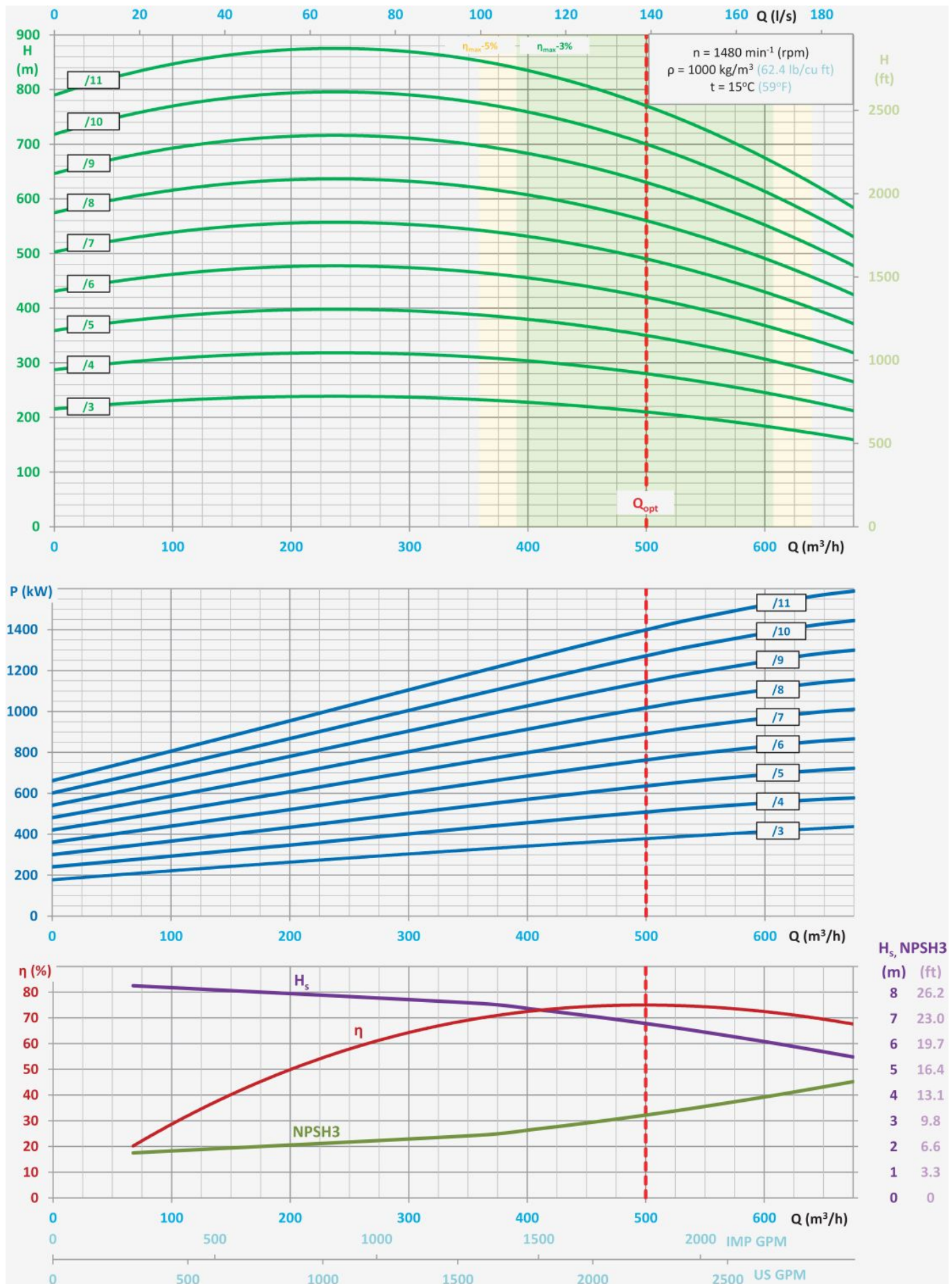

- $H = f(Q)$ - lift head acc. to rate flow,

- $P = f(Q)$ - power input acc. to rate flow,
- $\eta = f(Q)$ - efficiency acc. to rate of flow,
- $H_s = f(Q)$ - allowable suction head acc. to rate of flow,
- $NPSH_3 = f(Q)$ - net positive suction head and rate of flow.

MAIN DIMENSIONS OF PUMP

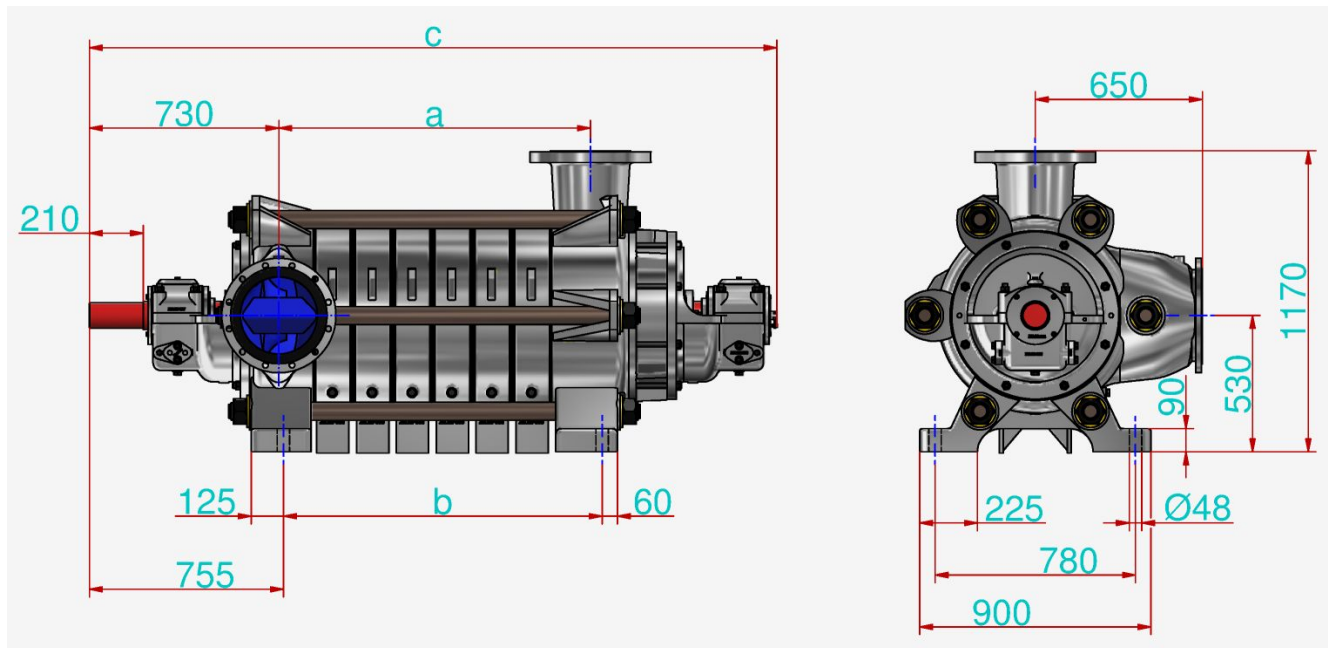

Number of stages										
	3	4	5	6	7	8	9	10	11	
a	593	748	903	1058	1213	1368	1523	1678	1833	mm
b	620	775	930	1085	1240	1395	1550	1705	1860	mm
c	2065	2220	2375	2530	2685	2840	2995	3150	3305	mm

CONNECTION SIZES OF PUMP

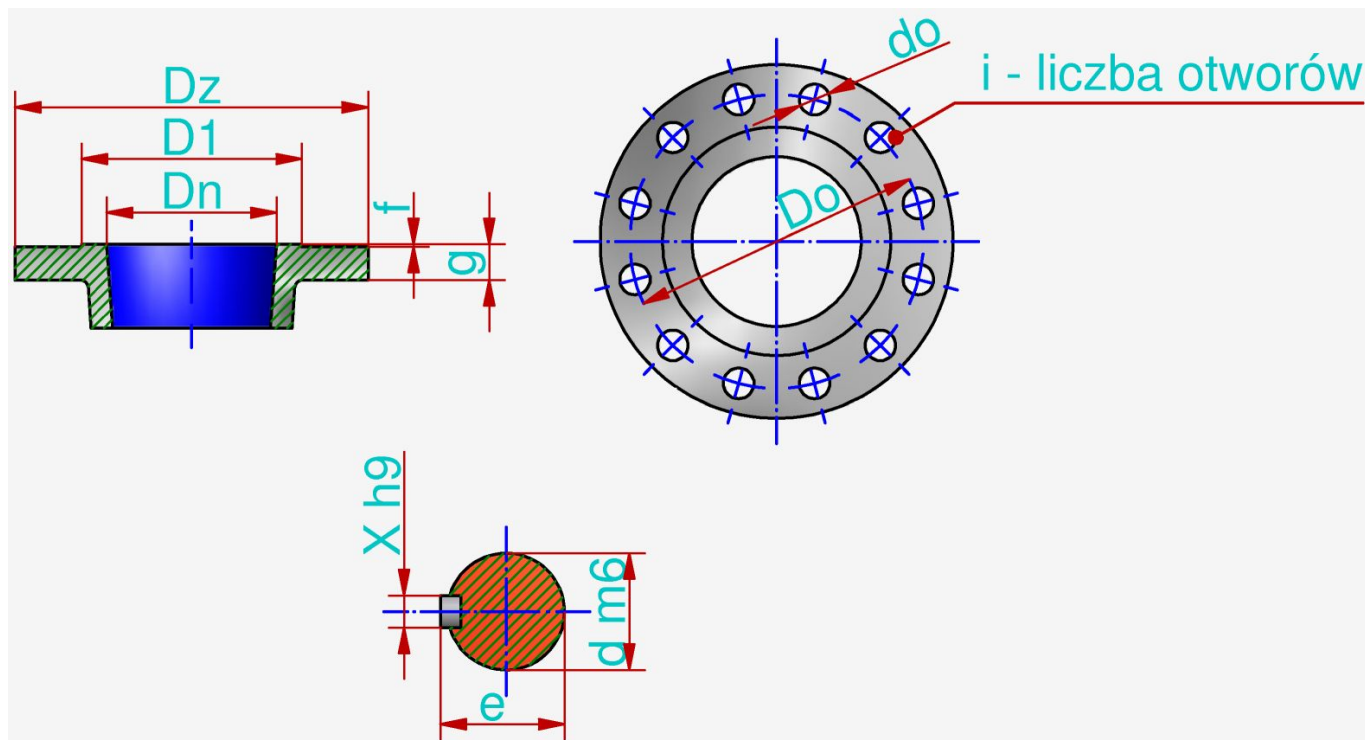

	D_n	Number of stages	P_n	D_z	d_o	g	F	D_o	D_1	i	d	e	x
Suction connector	300	-	10	445	22	26	4	400	370	12	-	-	-
Discharge connector	250	3÷5	40	450	33	38	3	385	345	12	-	-	-
		6÷8	63	470	36	46	4	400	312		-	-	-
		9÷11	100	505	39	60	4	430	312		-	-	-
Shaft / coupling	-	-	-	-	-	-	-	-	-	-	100	106	28
	mm	-	bar	mm	mm	mm	mm	mm	mm	-	mm	mm	mm

The flanges are normally made in accordance with the standard PN-EN 1092-1 or PN-EN 1092-2.

It is possible to produce pumps with parameters different than those presented in the tables and on the graphs per agreement with the manufacturer.