

# WPW-200



## DOWNLOAD



Catalog



2D



3D

---

## SAVE TO PDF / PRINT

---

**PUBLICATION - 2017-11-07**

## TYPICAL APPLICATIONS

- pumping of pure or mechanically contaminated water with solids with the grain size of up to 2 mm,
  - pressure boosting,
  - technological processes,
  - industrial systems,
  - mining – main and auxiliary dewatering,
  - coal, copper, salt mines and others.
-

# KEY ADVANTAGES

- long life ensured by the use of state-of-the-art corrosion- and erosion resistant materials,
  - special material execution DUPLEX especially resistant to difficult conditions,
  - possibility to use an electronic system of the balance disk wear monitoring,
  - connection dimensions in compliance with multi-stage drainage pumps,
  - approved for operation in explosion-hazard zones - ATEX Ex I M2.
- 

## PUMP PERFORMANCE CURVE

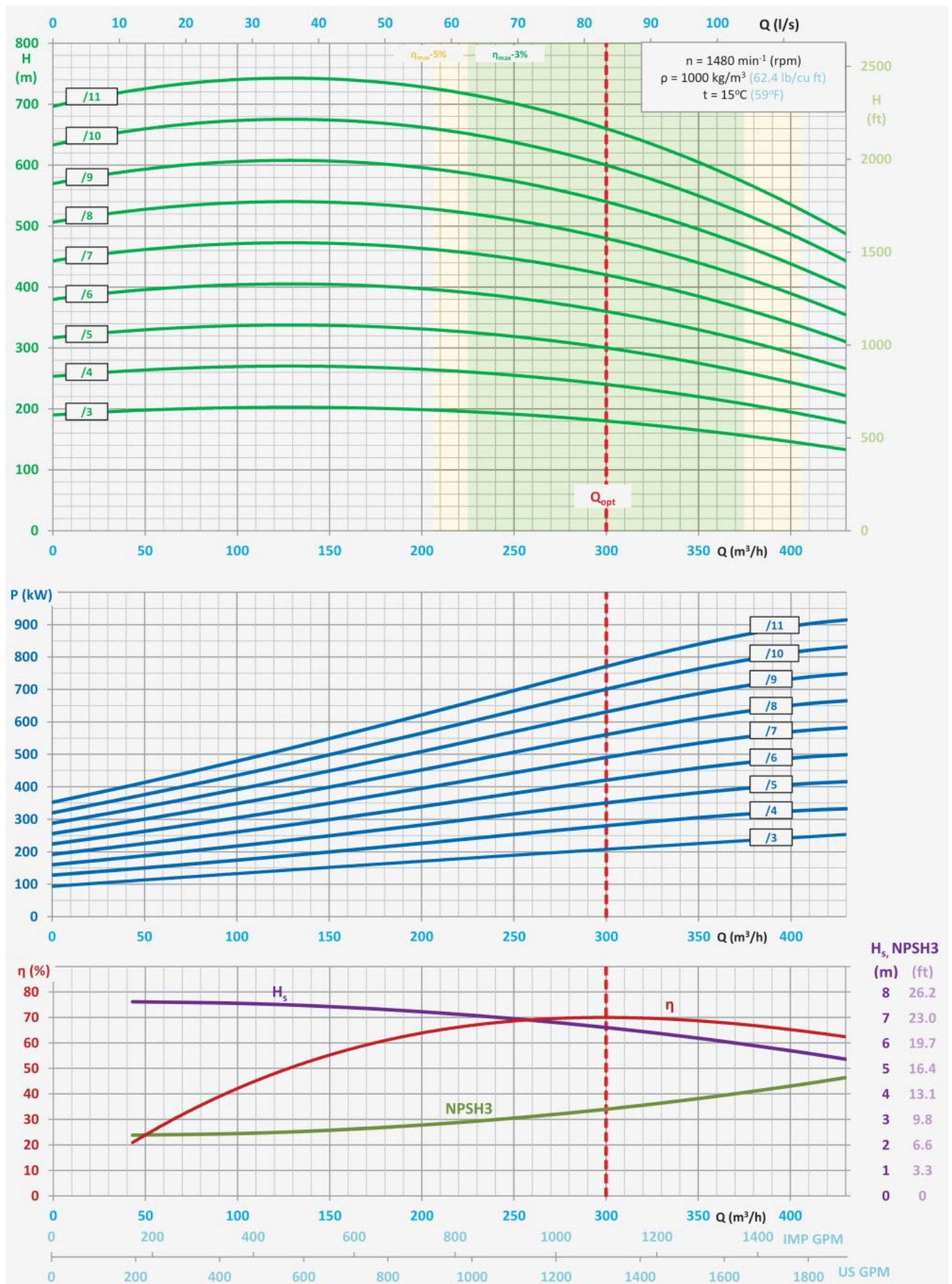

- $H = f(Q)$  - lift head acc. to rate flow,

- $P = f(Q)$  - power input acc. to rate flow,
- $\eta = f(Q)$  - efficiency acc. to rate of flow,
- $H_s = f(Q)$  - allowable suction head acc. to rate of flow,
- $NPSH_3 = f(Q)$  - net positive suction head and rate of flow.

## MAIN DIMENSIONS OF PUMP

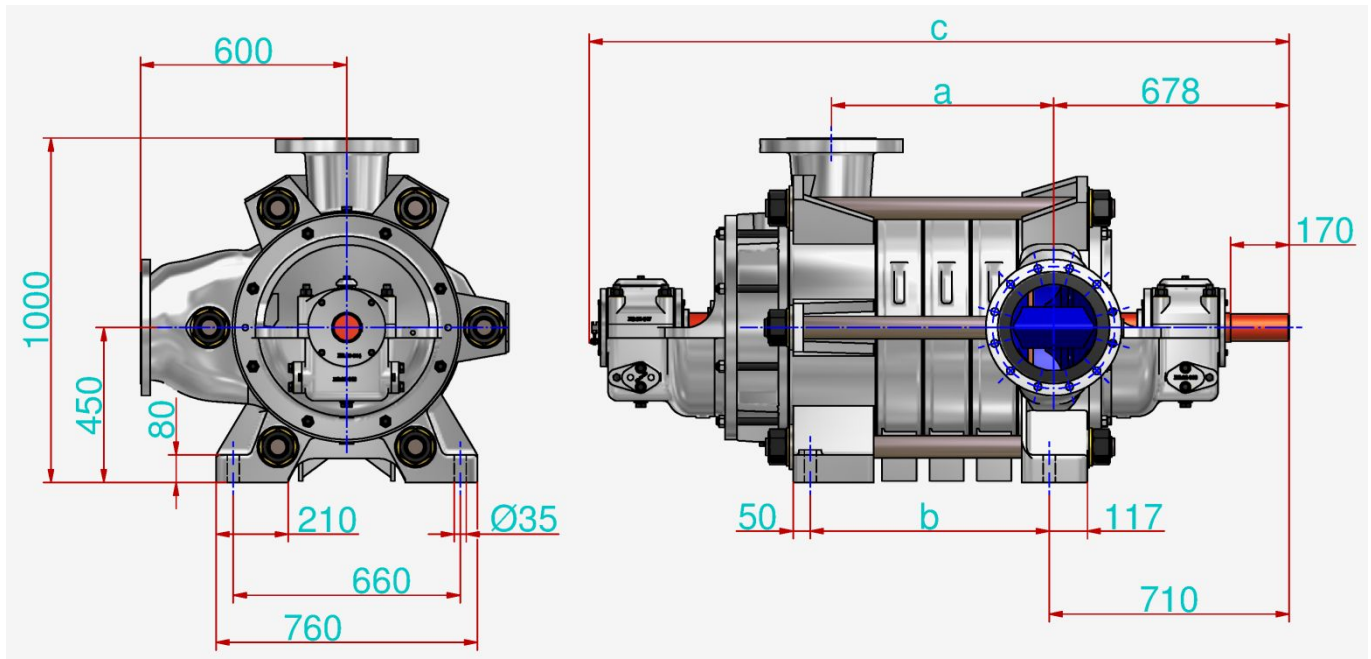

Number of stages										
	3	4	5	6	7	8	9	10	11	
<b>a</b>	1913	2051	2189	2327	2465	2603	2741	2879	3017	mm
<b>b</b>	548	686	824	962	1100	1238	1376	1514	1652	mm
<b>c</b>	507	645	783	921	1059	1197	1335	1473	1611	mm

## CONNECTION SIZES OF PUMP

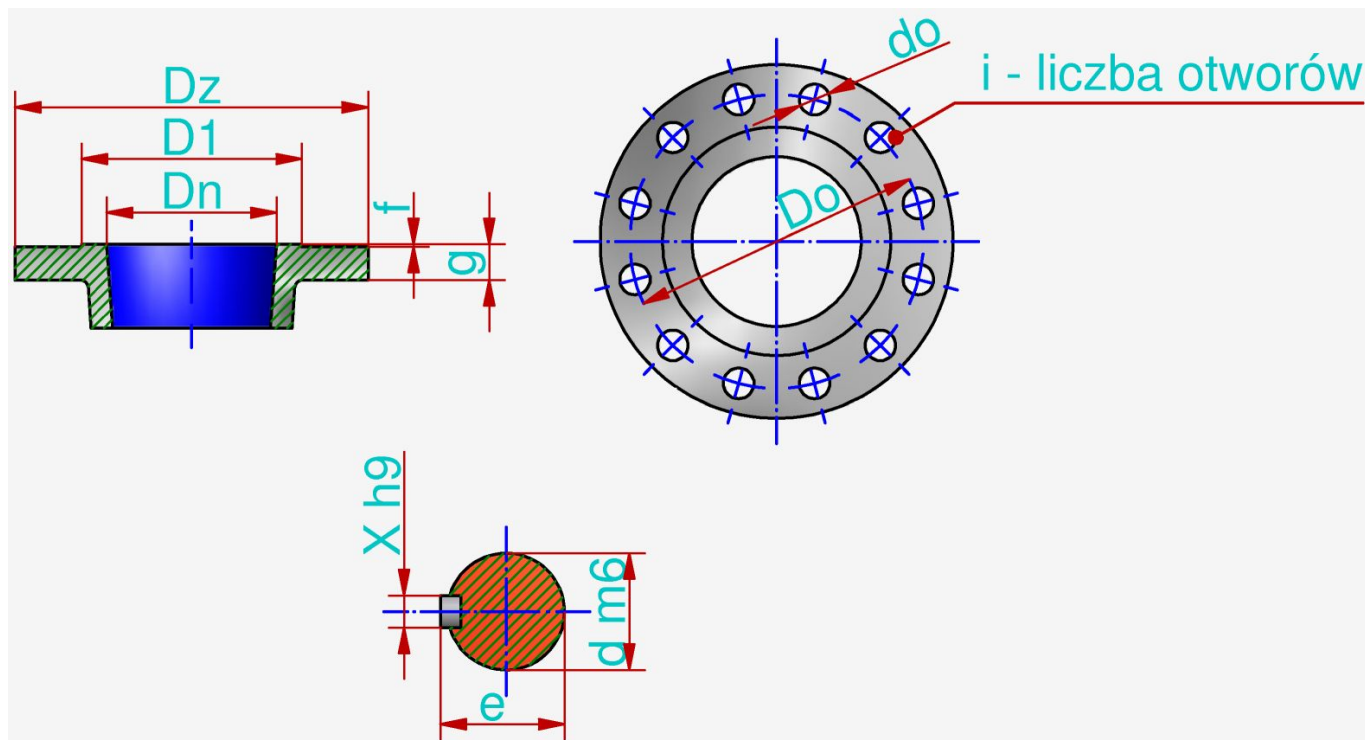

	$D_n$	Number of stages	$P_n$	$D_z$	$d_o$	$g$	$f$	$D_o$	$D_1$	$i$	$d$	$e$	$x$
Suction connector	250	-	10	395	22	26	3	350	320	12	-	-	-
Discharge connector	200	3÷6	40	375	30	34	3	320	280	12	-	-	-
		7÷10	63	415	36	42	4	345	259		-	-	-
		11	100	430	36	52	4	360	259		-	-	-
Shaft / coupling	-	-	-	-	-	-	-	-	-	-	80	85	22
	mm	-	bar	mm	mm	mm	mm	mm	mm	-	mm	mm	mm

The flanges are normally made in accordance with the standard PN-EN 1092-1 or PN-EN 1092-2.

**It is possible to produce pumps with parameters different than those presented in the tables and on the graphs per agreement with the manufacturer.**