

WPW-100



DOWNLOAD



Catalog



2D



3D

SAVE TO PDF / PRINT

PUBLICATION - 2017-11-07

TYPICAL APPLICATIONS

- pumping of pure or mechanically contaminated water with solids with the grain size of up to 2 mm,
 - pressure boosting,
 - technological processes,
 - industrial systems,
 - mining - main and auxiliary dewatering,
 - coal, copper, salt mines and others.
-

KEY ADVANTAGES

- long life ensured by the use of state-of-the-art corrosion- and erosion resistant materials,
 - special material execution DUPLEX especially resistant to difficult conditions,
 - possibility to use an electronic system of the balance disk wear monitoring,
 - connection dimensions in compliance with multi-stage drainage pumps,
 - approved for operation in explosion-hazard zones - ATEX Ex I M2.
-

PUMP PERFORMANCE CURVE

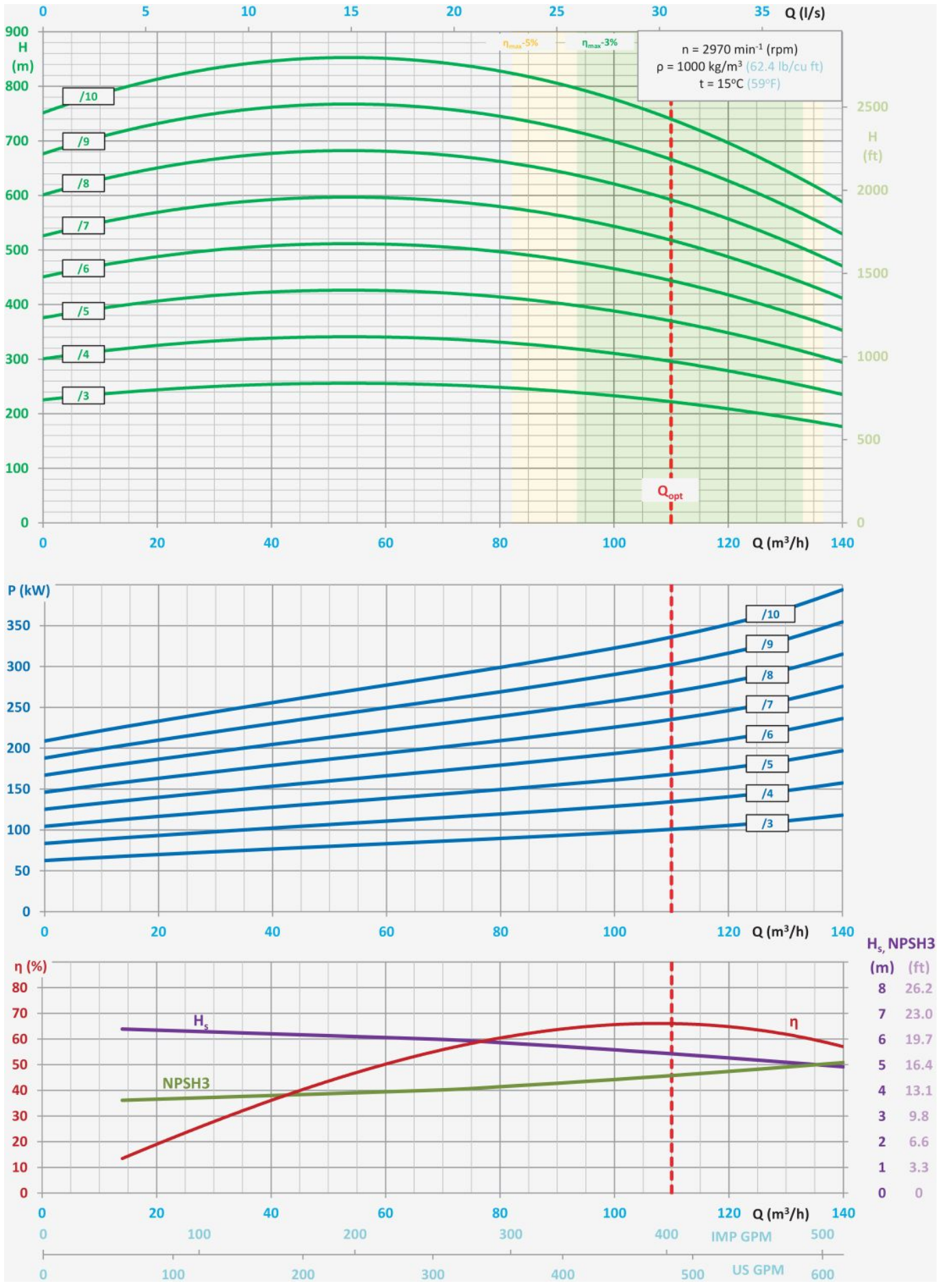

▪ $H = f(Q)$ - lift head acc. to rate flow,

- $P = f(Q)$ - power input acc. to rate flow,
- $\eta = f(Q)$ - efficiency acc. to rate of flow,
- $H_s = f(Q)$ - allowable suction head acc. to rate of flow,
- $NPSH3 = f(Q)$ - net positive suction head and rate of flow.

MAIN DIMENSIONS OF PUMP

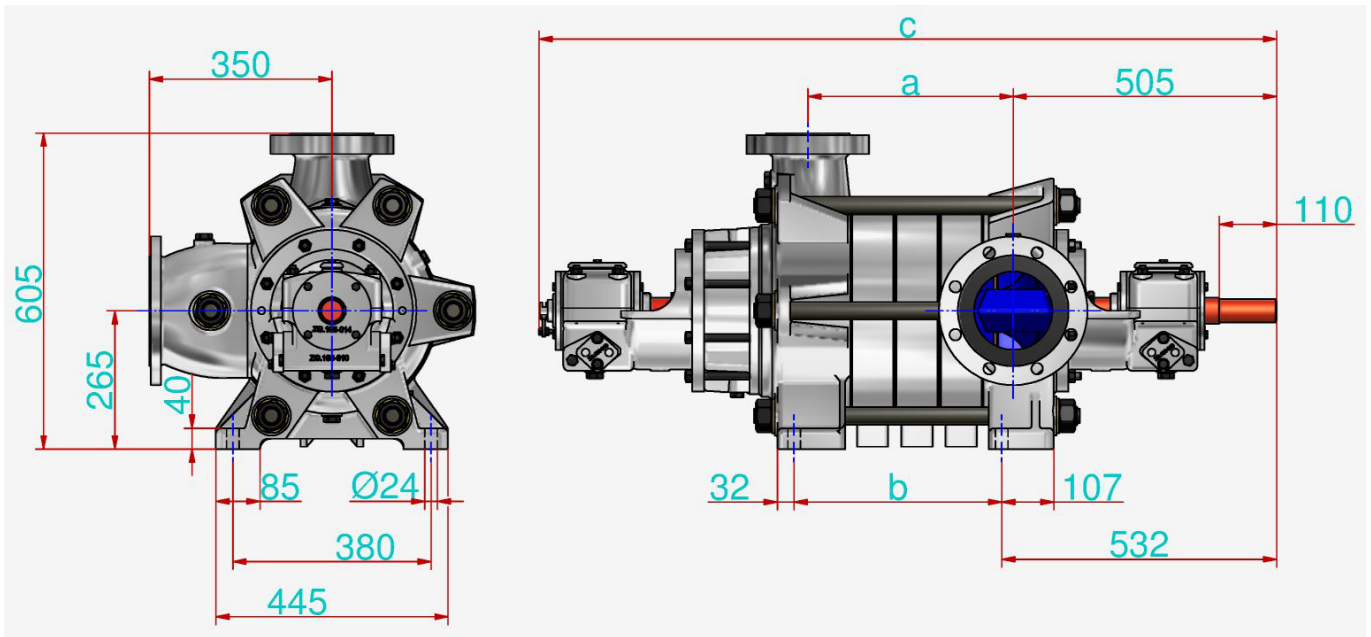

	Number of stages								
	3	4	5	6	7	8	9	10	
a	1341	1426	1511	1596	1681	1766	1851	1936	mm
b	299	384	469	554	639	724	809	894	mm
c	311	396	481	566	651	736	821	906	mm

CONNECTION SIZES OF PUMP

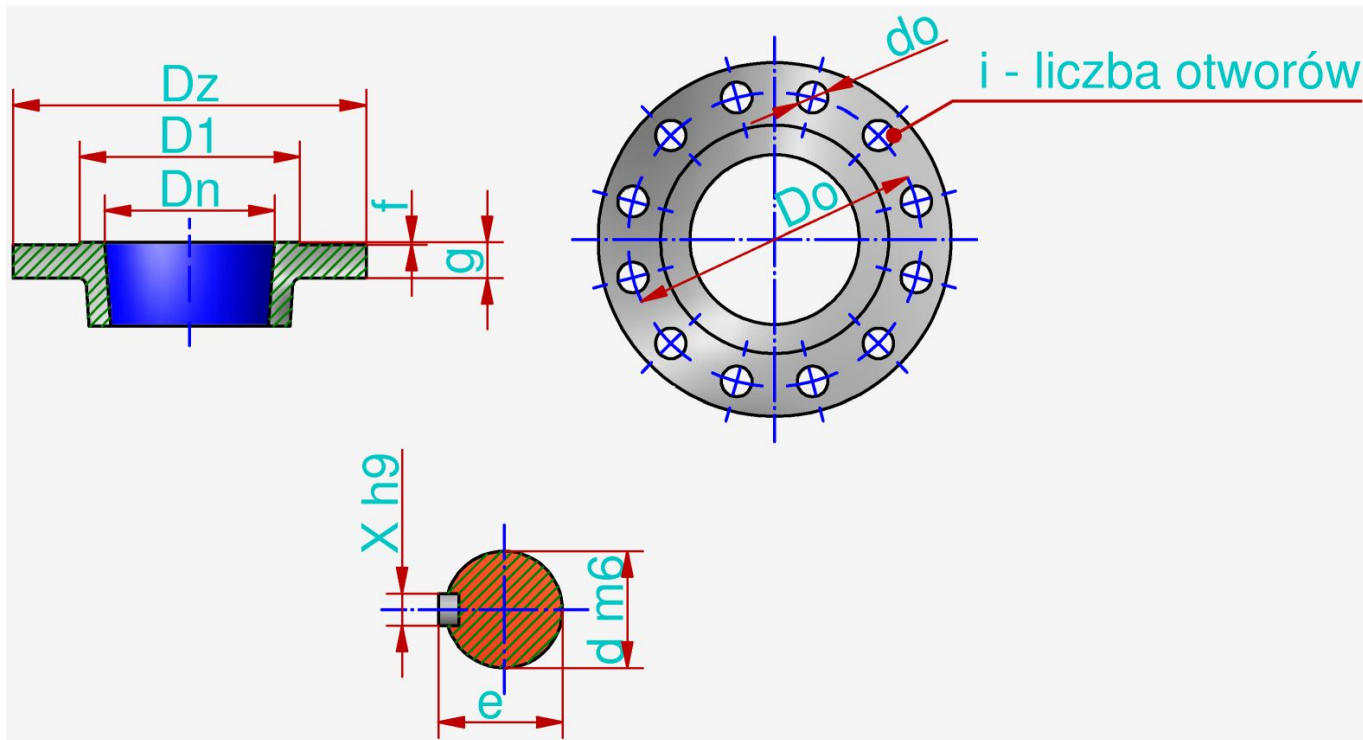

	D_n	Number of stages	P_n	D_z	d_o	g	f	D_o	D_1	i	d	e	x
Suction connector	150	-	10	285	22	22	3	240	212	8	-	-	-
Discharge connector	100	3÷5	40	235	22	40	3	190	162	8	-	-	-
		6÷8	63	250	26	40	4	200	149		-	-	-
		9÷10	100	265	30	40	4	210	149		-	-	-
Shaft / coupling	-	-	-	-	-	-	-	-	-	-	45	48,5	14
	mm	-	bar	mm	mm	mm	mm	mm	mm	-	mm	mm	mm

The flanges are normally made in accordance with the standard PN-EN 1092-1 or PN-EN 1092-2.

It is possible to produce pumps with parameters different than those presented in the tables and on the graphs per agreement with the manufacturer.