

WPCC-80



DOWNLOAD



Catalog



2D



3D

SAVE TO PDF / PRINT

PUBLICATION - 2017-11-07

**NOMINAL OPERATION PARAMETERS AT
PURE WATER PUMPING
(for the maximum rotation speed and the
largest rotor)**

Capacity	Q_n	90	m ³ /h
Head	H	19	m
Rotational speed	n	960*	rpm
Impeller diameter	D_z	375*	mm
Shaft power	P_n	8,5	kW
Weight	m	716	kg
Max. permissible size of solids		22	mm
Smallest flow cross-section		34	mm

*Pump construction enables decreasing the operational parameters by reducing the rotation speed and/or reducing the rotor's diameter, adapting the pump to the system without choking the pump.

TYPICAL APPLICATIONS

- pumping mixtures of water and solids, with large grains and highly abrasive properties,
 - pumping mixtures of water and quartz sand, ores, coal, slag, ash,
 - mining – WPCC pumps intended to replace heavy duty pumps used so far for,
 - technological processes,
 - industrial systems,
 - filtration systems.
-

KEY ADVANTAGES

- long life ensured by the use of state-of-the-art corrosion and erosion resistant materials,
- possibility of operation with a frequency converter,
- possibility of serial operation,
- the pumped mixture density can reach $\rho_{\max} = 2200\text{kg/m}^3$ while pumping

mixtures with a 50% content of solids in water,

- silent and smooth operation,
- connection dimensions in compliance with heavy duty pumps,
- inflow and suction operation,
- approved for operation in explosion-hazard zones – ATEX Ex I M2.

PUMP PERFORMANCE CURVE

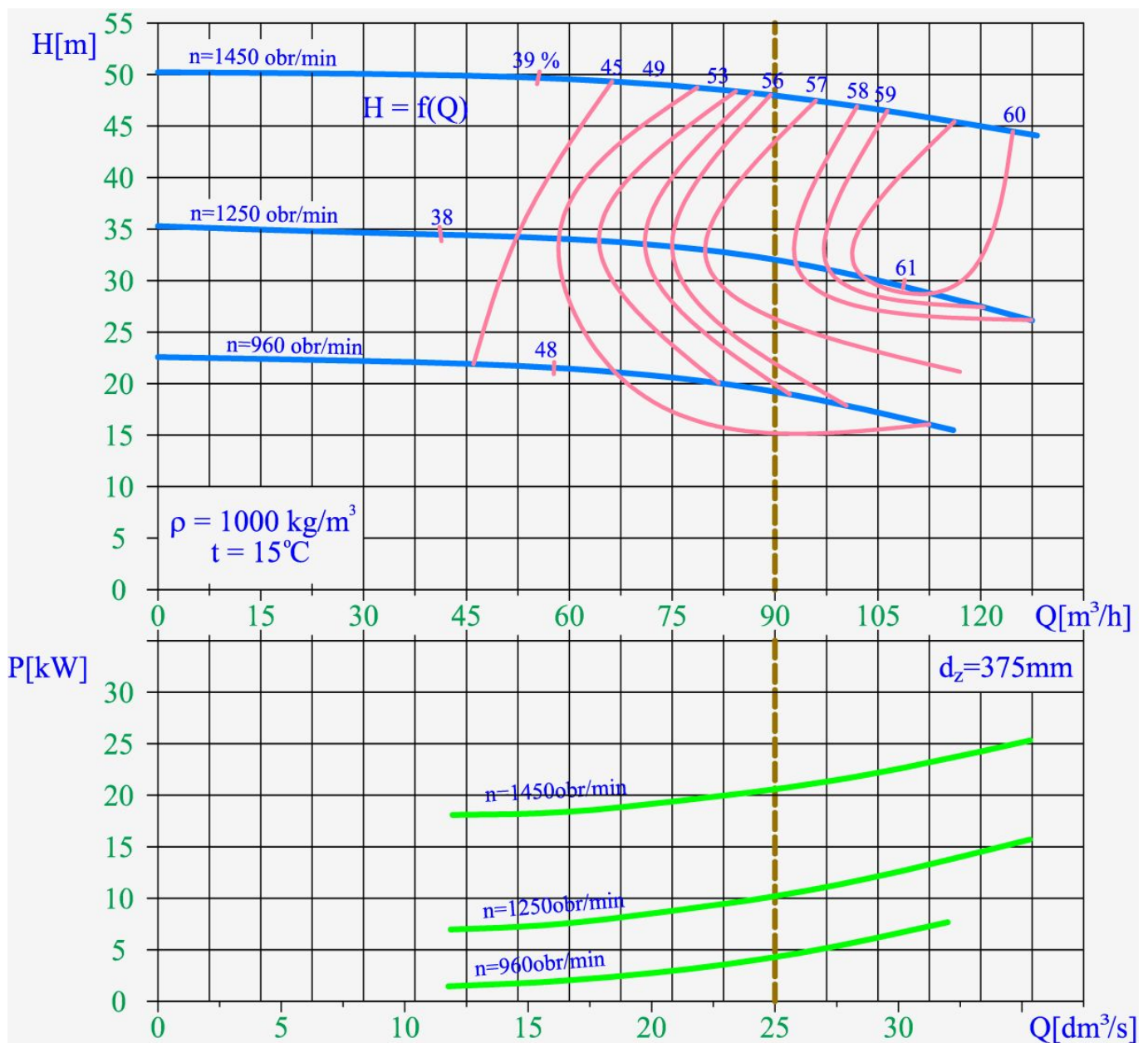

- $H = f(Q)$ – lift head acc. to rate flow,
- $P = f(Q)$ – power input acc. to rate flow,
- $\eta = f(Q)$ – efficiency acc. to rate of flow,

- d_z - impeller diameter,
- n - rotational speed.

MAIN DIMENSIONS OF PUMP

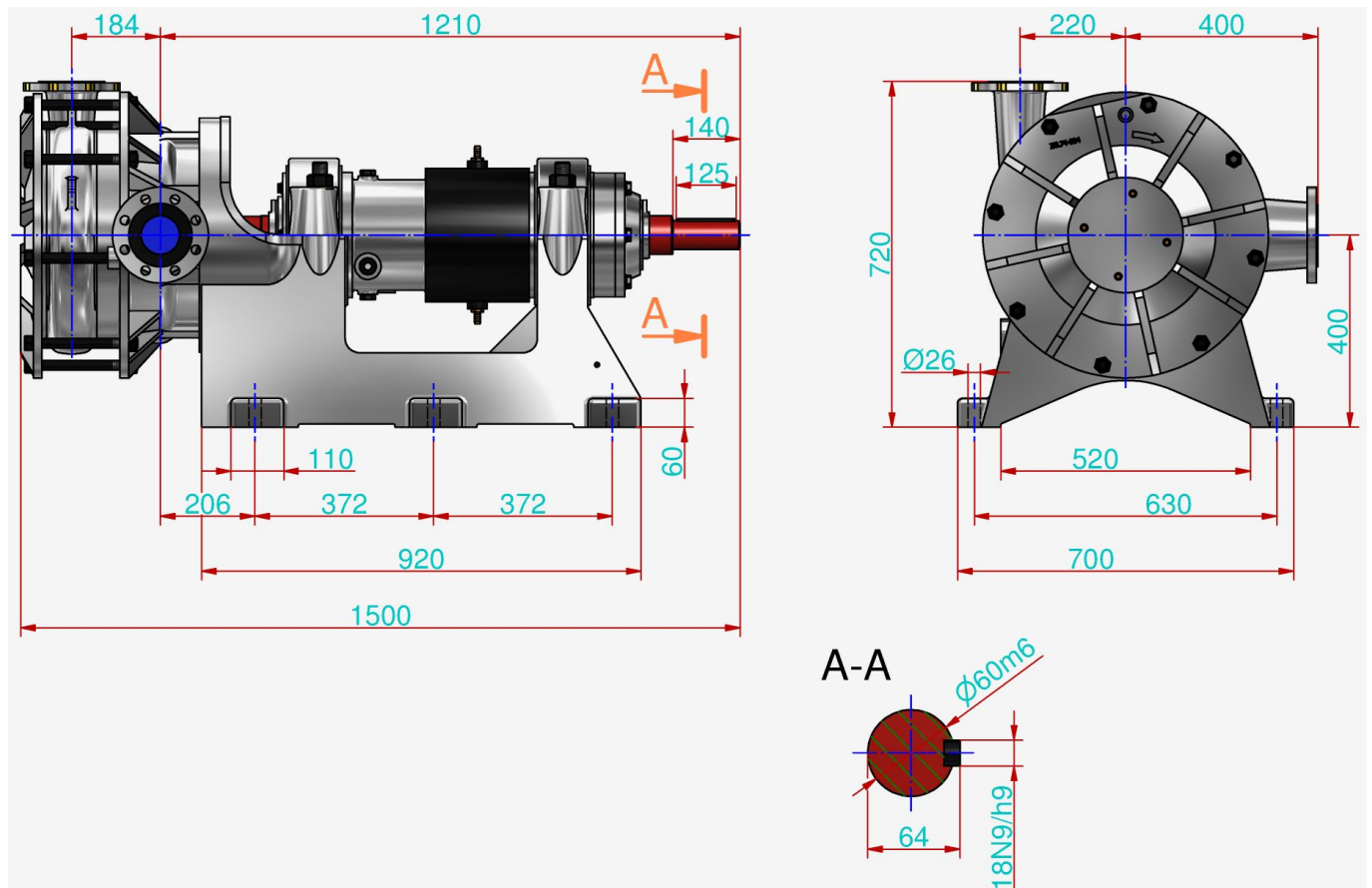

CONNECTION SIZES OF PUMP

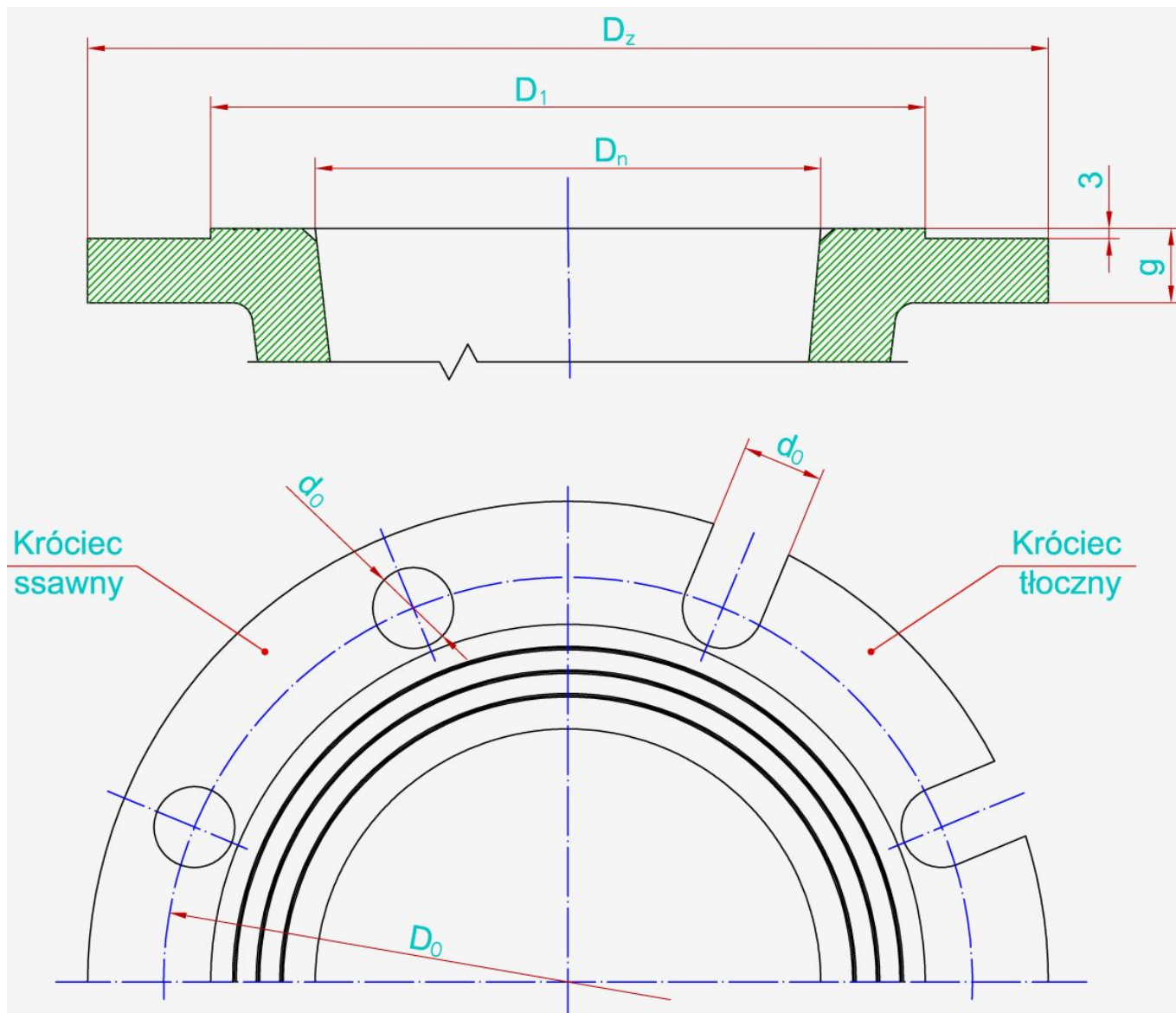

	D_n	i	D_z	d_0	g	D_0	D_1
Suction connector	80	8	200	19	22	160	132
Discharge connector	80	8	200	18	20	160	138
	mm	-	mm	mm	mm	mm	mm

The flanges are normally made in accordance with the standard PN-EN 1092-1 or PN-EN 1092-2.

MAIN DIMENSIONS OF PUMP UNIT

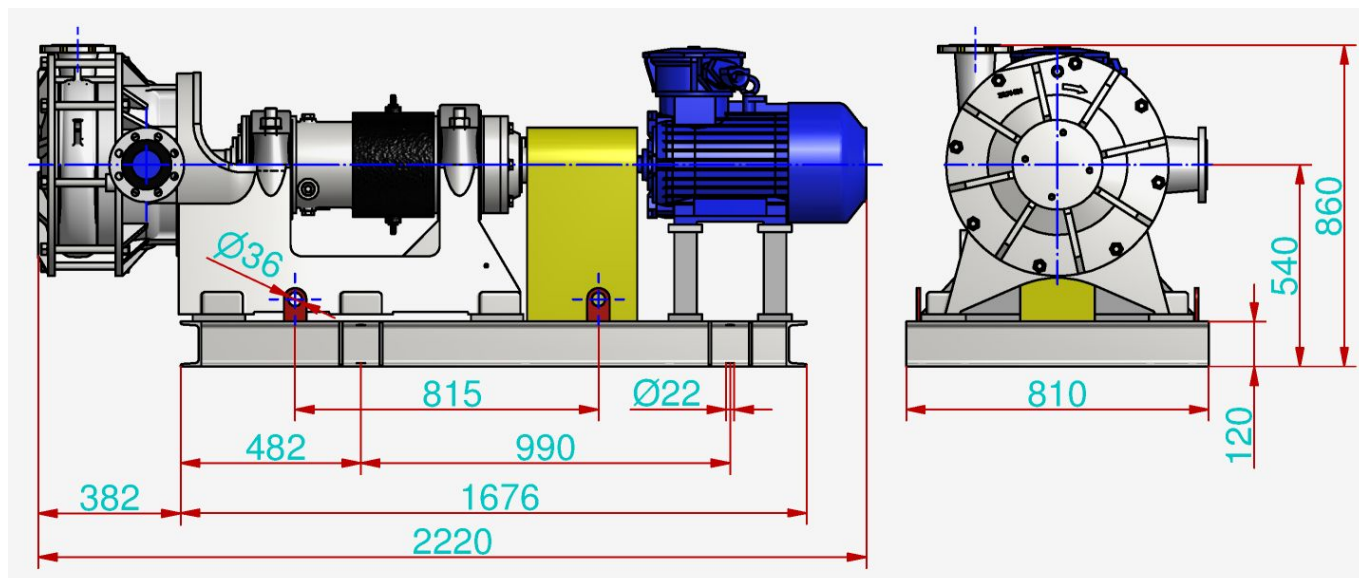

Motor type	Celma dSg160L6	-
Coupling type	V150	-
Weight	1100	kg

It is possible to produce pumps with parameters different than those presented in the tables and on the graphs per agreement with the manufacturer.