

# PHZ-100



## DOWNLOAD



Catalog



2D



3D

---

## SAVE TO PDF / PRINT

---

**PUBLICATION - 2017-11-07**

## NOMINAL OPERATION PARAMETERS AT PURE WATER PUMPING (for the maximum rotation speed and the largest rotor)

Capacity	$Q_n$	125	$m^3/h$
Head	$H$	40	m
Rotational speed	$n$	1600*	rpm
Impeller diameter	$D_z$	332*	mm
Shaft power	$P_n$	21	kW
Weight	$m$	359	kg
Max. permissible size of solids		14	mm

\*Pump construction enables decreasing the operational parameters by reducing the rotation speed and/or reducing the rotor's diameter, adapting the pump to the system without choking the pump.

---

## TYPICAL APPLICATIONS

- pumping mixtures of water and solids, with large grains and highly abrasive properties,
  - pumping mixtures of water and quartz sand, ores, coal, slag, ash,
  - mining - PHZ pumps intended to replace hydrotransport drainage pumps used so far,
  - water supply systems,
  - pressure boosting,
  - technological processes,
  - industrial systems,
  - filtration systems.
- 

## KEY ADVANTAGES

- long life ensured by the use of state-of-the-art corrosion and erosion resistant materials,
- possibility of operation with a frequency converter,
- possibility of serial operation,
- the pumped mixture density can reach  $\rho_{\max} = 1700\text{kg/m}^3$  while pumping mixtures with a 50% content of solids in water,
- silent and smooth operation,
- connection dimensions in compliance with hydrotransport pumps,
- inflow and suction operation,
- approved for operation in explosion-hazard zones - ATEX Ex I M2.

---

# PUMP PERFORMANCE CURVE

IN PROGRESS

---

## MAIN DIMENSIONS OF PUMP

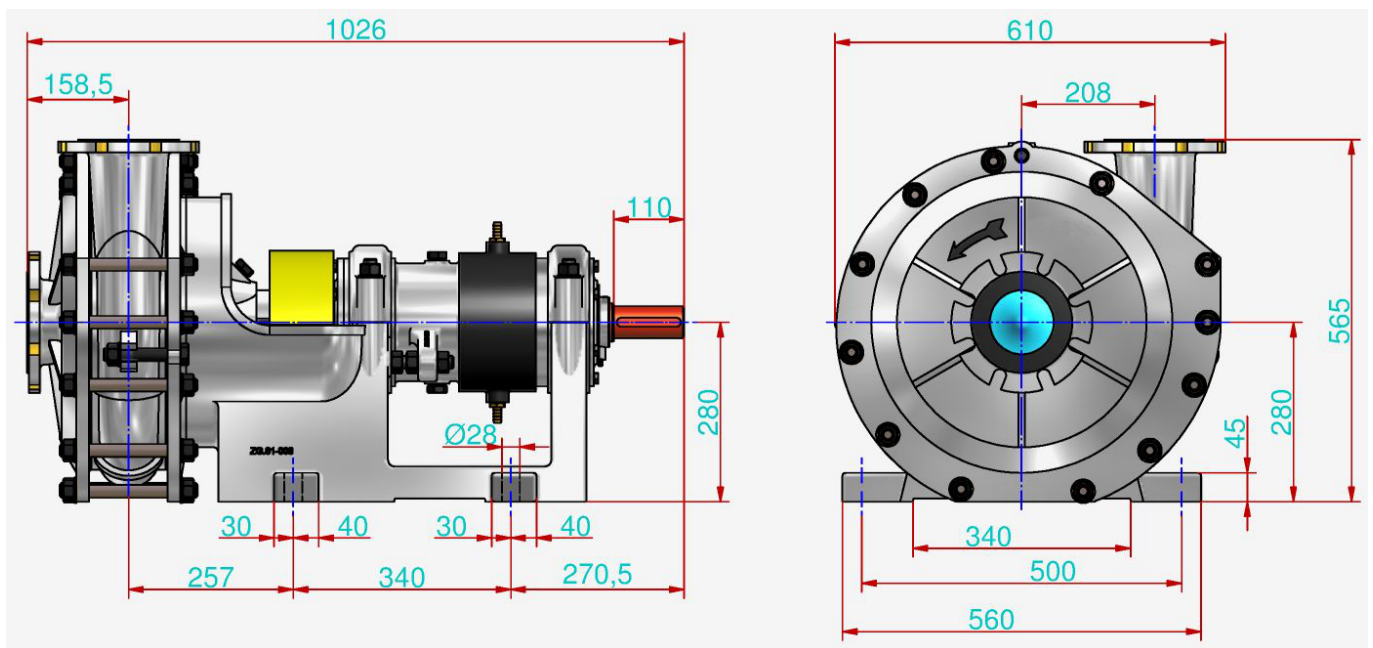

---

## CONNECTION SIZES OF PUMP

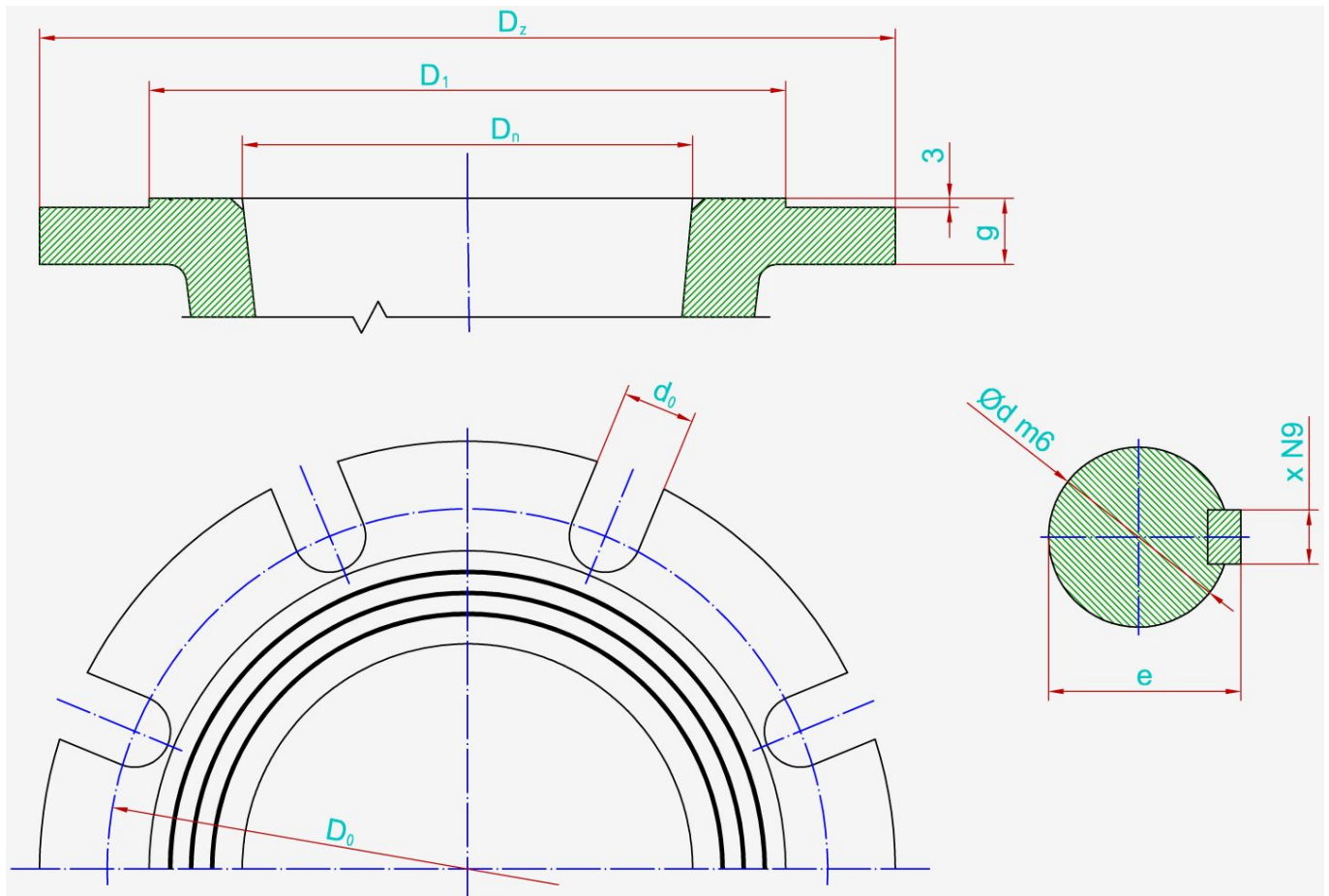

	$P_n$	$D_n$	$i$	$D_z$	$d_0$	$g$	$D_0$	$D_1$	$d$	$e$	$x$
<b>Suction connector</b>	16	100	8	220	19	20	180	158	-	-	-
<b>Discharge connector</b>	-	-	-	-	-	-	-	-	50	53,5	14
<b>Shaft / coupling</b>	bar	mm	-	mm	mm	mm	mm	mm	mm	mm	mm

The flanges are normally made in accordance with the standard PN-EN 1092-1 or PN-EN 1092-2.

## MAIN DIMENSIONS OF PUMP UNIT

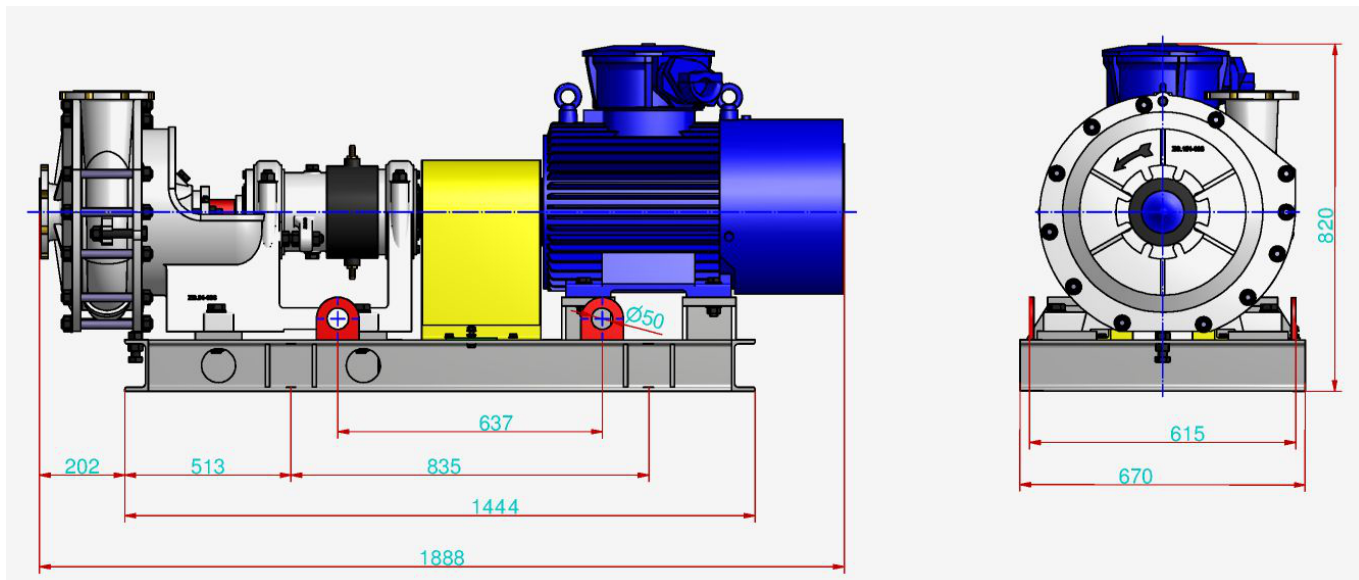

<b>Motor type</b>	Celma dSg200L4	-
<b>Coupling type</b>	V130	-
<b>Weight</b>	844	kg

**It is possible to produce pumps with parameters different than those presented in the tables and on the graphs per agreement with the manufacturer.**