

WPWH-250

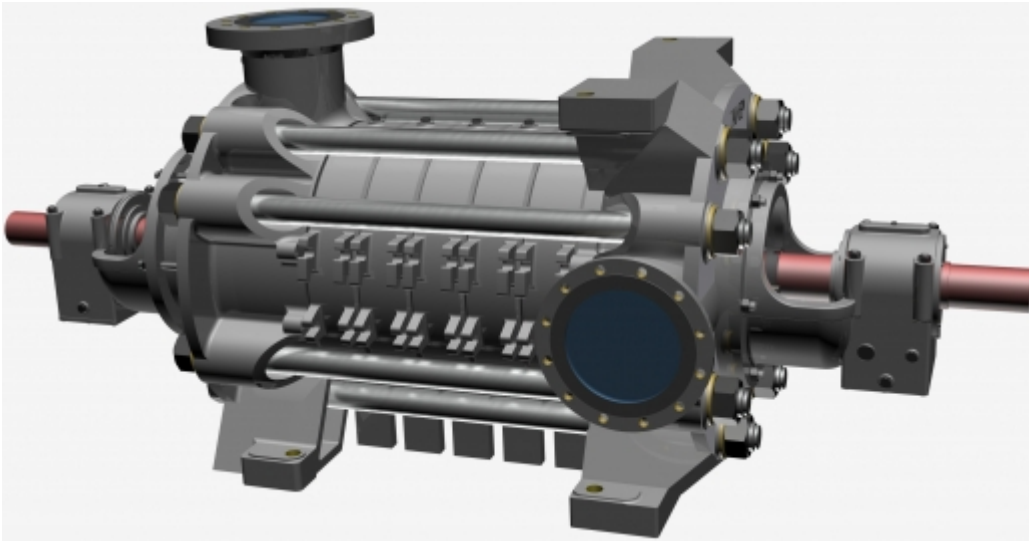

DOWNLOAD



Catalog



2D



3D

SAVE TO PDF / PRINT

PUBLICATION – 2017-11-07

TYPICAL APPLICATIONS

- pumping of pure or mechanically contaminated water with solids with the grain size of up to 2 mm,
- pressure boosting,

- technological processes,
 - industrial systems,
 - mining – main and auxiliary dewatering.
-

KEY ADVANTAGES

- long life ensured by the use of state-of-the-art corrosion- and erosion resistant materials,
 - special material execution DUPLEX especially resistant to difficult conditions,
 - possibility to use an electronic system of the balance disk wear monitoring,
 - connection dimensions in compliance with multi-stage drainage pumps,
 - approved for operation in explosion-hazard zones – ATEX Ex I M2.
-

PUMP PERFORMANCE CURVE

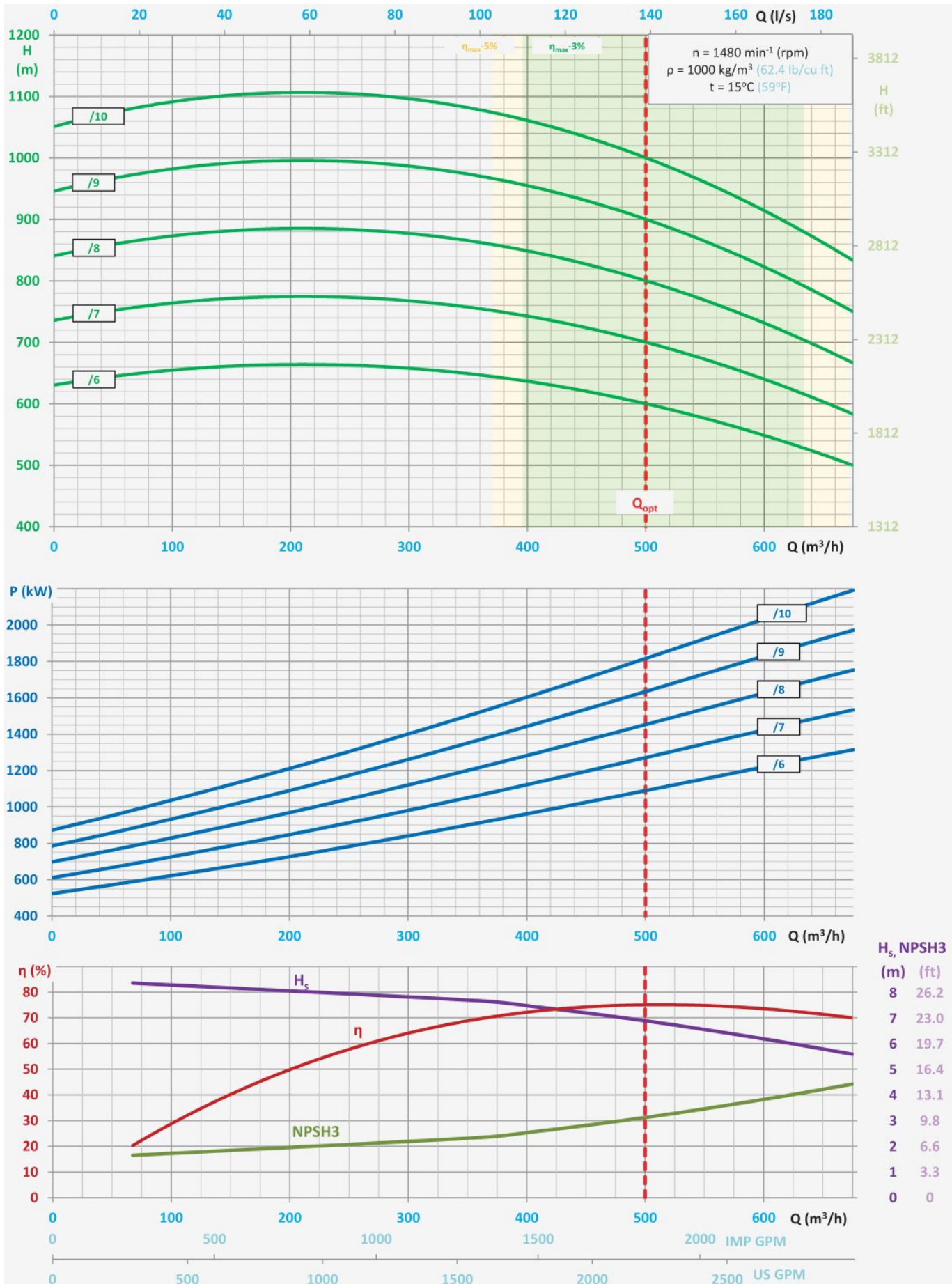

▪ $H = f(Q)$ – lift head acc. to rate flow,

- $P = f(Q)$ – power input acc. to rate of flow,
- $\eta = f(Q)$ – efficiency acc. to rate of flow,
- $H_s = f(Q)$ – allowable suction head acc. to rate of flow,
- $NPSH3 = f(Q)$ – net positive suction head and rate of flow.

MAIN DIMENSIONS OF PUMP

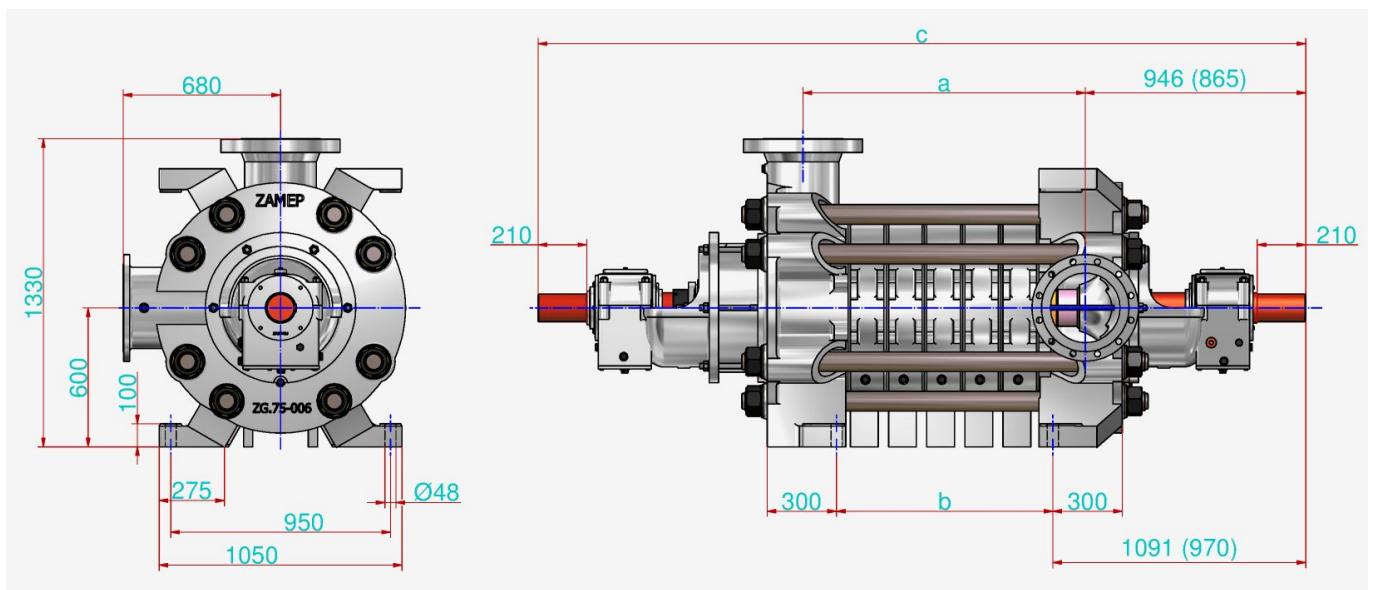

The dimensions of pump version only in flow operation are presented in parenthesis.

Only-suction version:

	Number of stages					
	6	7	8	9	10	
a	1220	1385	1550	1715	1880	mm
b	935	1100	1265	1430	1595	mm
c	3154	3483*	3648*	3813*	3978*	mm

* – with double-sided drive,

Only-flow version:

	Number of stages					
	6	7	8	9	10	
a	1180	1345	1510	1675	1840	mm
b	935	1100	1265	1430	1595	mm
c	3033	3198	3363	3692*	3857*	mm

* – with double-sided drive,

CONNECTION SIZES OF PUMP

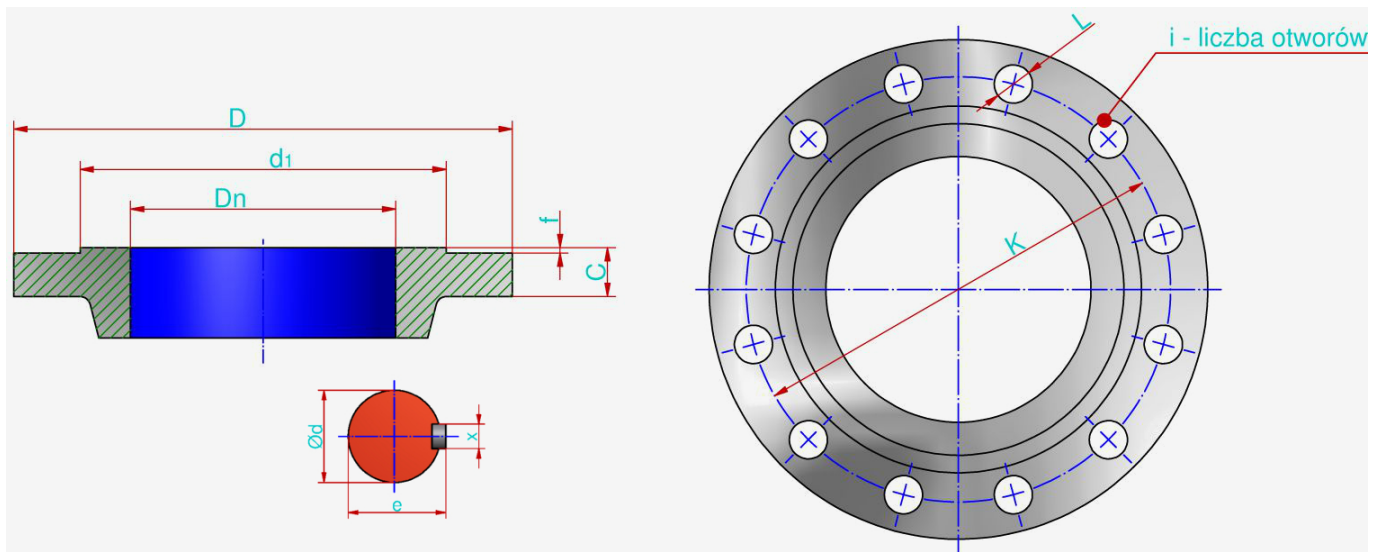

	P_n	D_n	D	K	L	i	C	f	d_1	d	e	x
Suction connector	16	300	460	410	26	12	28	2	378	-	-	-
Discharge connector	63	250	470	400	36	12	46	2	345	-	-	-
	160	250	505	430	39	12	60	2	345	-	-	-
Shaft / coupling	-	-	-	-	-	-	-	-	-	120	127	32
	bar	mm	mm	mm	mm	-	mm	mm	mm	mm	mm	mm

The flanges are normally made in accordance with the standard PN-EN 1092-1 or PN-EN 1092-2.

It is possible to produce pumps with parameters different than those presented in the tables and on the graphs per agreement with the manufacturer.

